

1) Cut the two zip ties that are holding the sling and the arm

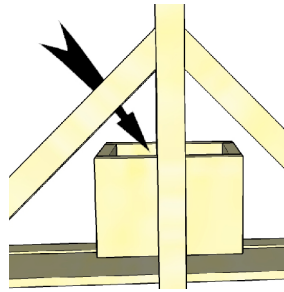

2) Fill the counterweight basket with weight (coins, sand, bolts, etc.)

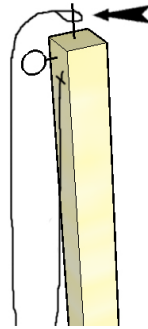

3) Place the looped end of the string over the pin on the end of the arm. Note: You can bend the pin forward or backward to make the projectile release earlier or later. Use plyers.

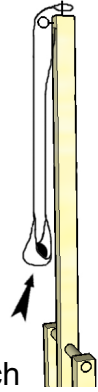

4) Load the projectile object (ball) into the pouch

5) Tilt the arm down. Place the eye bolt on the arm between the two eye bolts on the base. Insert the trigger through all three eye bolts.

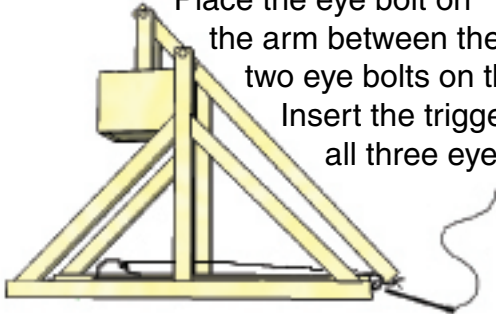

6) Place the pouch and projectile object onto the trough

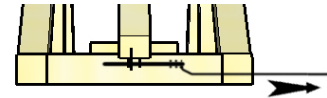
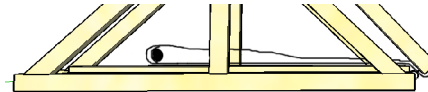

7) Move to the side of the trebuchet, pull the trigger and watch it fly!

Mini Trebuchet Instructions

www.oaklandballistics.com - info@oaklandballistics.com

* Caution: The pin on the end of the throwing arm is sharp. Be careful to avoid this area whenever tilting the throwing arm or firing the trebuchet. Always step to the side of the trebuchet before firing it. Use this trebuchet at your own risk.